

Materials: Case Hardened Steel
 Hardness: 62 +/- 2 Hrc

d1	d3	z	Product Code -Short	Short Length	Product Code -Long	Long Length
0.4	3.0	0.01			DG179-004-3-9L	9
0.5	3.0	0.01			DG179-005-3-9L	9
0.6	3.0	0.01			DG179-006-3-9L	9
0.7	3.0	0.01			DG179-007-3-9L	9
0.8	3.0	0.01	DG179-008-3-6S	6	DG179-008-3-9L	9
0.9	3.0	0.01	DG179-009-3-6S	6	DG179-009-3-9L	9
1.0	3.0	0.01	DG179-010-3-6S	6	DG179-010-3-9L	9
1.1	4.0	0.01			DG179-011-4-9L	9
1.2	4.0	0.01	DG179-012-4-6S	6	DG179-012-4-9L	9
1.5	4.0	0.01	DG179-015-4-6S	6	DG179-015-4-9L	9
1.6	4.0	0.01	DG179-016-4-6S	6	DG179-016-4-9L	9
1.7	4.0	0.01			DG179-017-4-9L	9
1.8	4.0	0.01			DG179-018-4-9L	9
1.9	5.0	0.01			DG179-019-5-9L	9
2.0	5.0	0.01	DG179-020-5-6S	6	DG179-020-5-9L	9
2.1	5.0	0.01			DG179-021-5-9L	9
2.2	5.0	0.01	DG179-022-5-6S	6	DG179-022-5-9L	9
2.3	5.0	0.01			DG179-023-5-9L	9
2.4	5.0	0.01	DG179-024-5-6S	6	DG179-024-5-9L	9
2.5	5.0	0.01	DG179-025-5-6S	6	DG179-025-5-9L	9
2.6	5.0	0.01	DG179-026-5-6S	6	DG179-026-5-9L	9
2.7	6.0	0.01	DG179-027-6-8S	8	DG179-027-6-12L	12
2.8	6.0	0.01	DG179-028-6-8S	8	DG179-028-6-12L	12
2.9	6.0	0.01	DG179-029-6-8S	8	DG179-029-6-12L	12
3.0	6.0	0.01	DG179-030-6-8S	8	DG179-030-6-12L	12
3.1	6.0	0.01	DG179-031-6-8S	8	DG179-031-6-12L	12
3.2	6.0	0.01	DG179-032-6-8S	8	DG179-032-6-12L	12
3.3	6.0	0.01	DG179-033-6-8S	8	DG179-033-6-12L	12
3.4	7.0	0.01	DG179-034-7-8S	8	DG179-034-7-12L	12
3.5	7.0	0.01	DG179-035-7-8S	8	DG179-035-7-12L	12
3.6	7.0	0.01	DG179-036-7-8S	8	DG179-036-7-12L	12
3.7	7.0	0.01	DG179-037-7-8S	8	DG179-037-7-12L	12
3.8	7.0	0.01	DG179-038-7-8S	8	DG179-038-7-12L	12
3.9	7.0	0.01			DG179-039-7-12L	12
4.0	7.0	0.01	DG179-040-7-8S	8	DG179-040-7-12L	12
4.1	8.0	0.01	DG179-041-8-8S	8	DG179-041-7-12L	12
4.2	8.0	0.01	DG179-042-8-8S	8	DG179-042-7-12L	12
4.3	8.0	0.01	DG179-043-8-8S	8	DG179-043-7-12L	12
4.4	8.0	0.01	DG179-044-8-8S	8	DG179-044-7-12L	12
4.5	8.0	0.01	DG179-045-8-8S	8	DG179-045-8-12L	12
4.6	8.0	0.01	DG179-046-8-8S	8	DG179-046-8-12L	12
4.7	8.0	0.01			DG179-047-8-12L	12
4.8	8.0	0.01	DG179-048-8-8S	8	DG179-048-8-12L	12
4.9	8.0	0.01			DG179-049-8-12L	12

Continued next page

Precision Drill Guides (Headless)

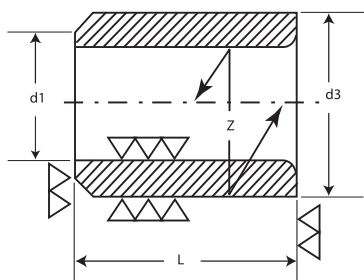

Materials: Case Hardened Steel
 Hardness: 62 +/- 2 Hrc

d1	d3	z	Product Code -Short	Short Length	Product Code -Long	Long Length
5.0	8.0	0.01	DG179-050-8-8S	8	DG179-050-8-12L	12
5.1	10.0	0.02	DG179-051-10-10S	10	DG179-051-10-16L	16
5.2	10.0	0.02	DG179-052-10-10S	10	DG179-052-10-16L	16
5.3	10.0	0.02	DG179-053-10-10S	10	DG179-053-10-16L	16
5.4	10.0	0.02	DG179-054-10-10S	10	DG179-054-10-16L	16
5.5	10.0	0.02	DG179-055-10-10S	10	DG179-055-10-16L	16
5.6	10.0	0.02	DG179-056-10-10S	10	DG179-056-10-16L	16
5.7	10.0	0.02			DG179-057-10-16L	16
5.8	10.0	0.02	DG179-058-10-10S	10	DG179-058-10-16L	16
5.9	10.0	0.02			DG179-059-10-16L	16
6.0	10.0	0.02	DG179-060-10-10S	10	DG179-060-10-16L	16
6.1	12.0	0.02	DG179-061-12-10S	10	DG179-061-10-16L	16
6.2	12.0	0.02	DG179-062-12-10S	10	DG179-062-10-16L	16
6.3	12.0	0.02	DG179-063-12-10S	10	DG179-063-10-16L	16
6.4	12.0	0.02	DG179-064-12-10S	10	DG179-064-10-16L	16
6.5	12.0	0.02	DG179-065-12-10S	10	DG179-065-10-16L	16
6.6	12.0	0.02	DG179-066-12-10S	10	DG179-066-10-16L	16
6.7	12.0	0.02	DG179-067-12-10S	10	DG179-067-10-16L	16
6.8	12.0	0.02	DG179-068-12-10S	10	DG179-068-10-16L	16
6.9	12.0	0.02	DG179-069-12-10S	10	DG179-069-10-16L	16
7.0	12.0	0.02	DG179-070-12-10S	10	DG179-070-10-16L	16
7.1	12.0	0.02	DG179-071-12-10S	10	DG179-071-10-16L	16
7.2	12.0	0.02	DG179-072-12-10S	10	DG179-072-10-16L	16
7.3	12.0	0.02	DG179-073-12-10S	10	DG179-073-10-16L	16
7.5	12.0	0.02	DG179-075-12-10S	10	DG179-075-10-16L	16
7.6	12.0	0.02	DG179-076-12-10S	10	DG179-076-10-16L	16
7.7	12.0	0.02			DG179-077-10-16L	16
7.8	12.0	0.02			DG179-078-10-16L	16
7.9	12.0	0.02	DG179-079-12-10S	10	DG179-079-10-16L	16
8.0	12.0	0.02	DG179-080-12-10S	10	DG179-080-10-16L	16
8.0	12.0	0.02	DG179-080-12-12S	12		
8.1	15.0	0.02	DG179-081-15-12S	12	DG179-081-15-20L	20
8.2	15.0	0.02	DG179-082-15-12S	12	DG179-082-15-20L	20
8.3	15.0	0.02	DG179-083-15-12S	12	DG179-083-15-20L	20
8.4	15.0	0.02			DG179-084-15-20L	20
8.5	15.0	0.02	DG179-085-15-12S	12		
8.6	15.0	0.02			DG179-086-15-20L	20
8.7	15.0	0.02			DG179-087-15-20L	20
8.8	15.0	0.02			DG179-088-15-20L	20
8.9	15.0	0.02			DG179-089-15-20L	20
9.0	15.0	0.02			DG179-090-15-20L	20
9.1	15.0	0.02			DG179-091-15-20L	20
9.2	15.0	0.02			DG179-092-15-20L	20
9.3	15.0	0.02	DG179-093-15-12S	12	DG179-093-15-20L	20
9.4	15.0	0.02			DG179-094-15-20L	20

Continued next page

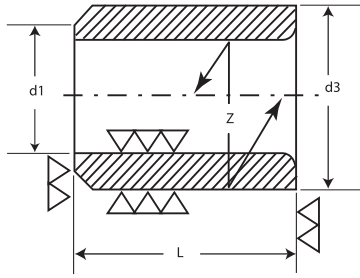

Materials: Case Hardened Steel
 Hardness: 62 +/- 2 Hrc

d1	d3	z	Product Code -Short	Short Length	Product Code -Long	Long Length
9.5	15.0	0.02	DG179-095-15-12S	12	DG179-095-15-20L	20
9.6	15.0	0.02	DG179-096-15-12S	12	DG179-096-15-20L	20
9.7	15.0	0.02	DG179-097-15-12S	12	DG179-097-15-20L	20
9.8	15.0	0.02			DG179-098-15-20L	20
9.9	15.0	0.02			DG179-099-15-20L	20
10.0	15.0	0.02	DG179-100-15-12S	12	DG179-100-15-20L	20
10.0	18.0	0.02	DG179-100-18-12S	12		
10.1	18.0	0.02	DG179-101-18-12S	12	DG179-101-18-20L	20
10.2	18.0	0.02			DG179-102-18-20L	20
10.3	18.0	0.02			DG179-103-18-20L	20
10.4	18.0	0.02			DG179-104-18-20L	20
10.5	18.0	0.02	DG179-105-18-12S	12	DG179-105-18-20L	20
10.6	18.0	0.02	DG179-106-18-12S	12	DG179-106-18-20L	20
10.7	18.0	0.02			DG179-107-18-20L	20
10.8	18.0	0.02			DG179-108-18-20L	20
10.9	18.0	0.02			DG179-109-18-20L	20
11.0	18.0	0.02	DG179-110-18-12S	12	DG179-110-18-20L	20
11.1	18.0	0.02			DG179-111-18-20L	20
11.2	18.0	0.02			DG179-112-18-20L	20
11.3	18.0	0.02			DG179-113-18-20L	20
11.4	18.0	0.02			DG179-114-18-20L	20
11.5	18.0	0.02	DG179-115-18-12S	12	DG179-115-18-20L	20
11.7	18.0	0.02			DG179-117-18-20L	20
12.0	18.0	0.02	DG179-120-18-12S	12	DG179-120-18-20L	20
12.5	22.0	0.02	DG179-125-22-16S	16	DG179-125-22-22L	22
12.7	22.0	0.02	DG179-127-22-16S	16		
13.0	22.0	0.02	DG179-130-22-16S	16	DG179-130-22-22L	22
13.5	22.0	0.02	DG179-135-22-16S	16	DG179-135-22-22L	22
14.0	22.0	0.02	DG179-140-22-16S	16	DG179-140-22-22L	22
14.5	22.0	0.02	DG179-145-22-16S	16	DG179-145-22-22L	22
15.0	22.0	0.02	DG179-150-22-16S	16	DG179-150-22-22L	22
15.5	26.0	0.02	DG179-155-26-16S	16	DG179-155-26-22L	22
16.0	26.0	0.02	DG179-160-26-16S	16	DG179-160-26-22L	22
16.5	26.0	0.02	DG179-165-26-16S	16	DG179-165-26-22L	22
17.0	26.0	0.02	DG179-170-26-16S	16	DG179-170-26-22L	22
18.0	26.0	0.02	DG179-180-26-16S	16	DG179-180-26-22L	22
18.5	30.0	0.02	DG179-185-30-20S	20		
19.0	30.0	0.02	DG179-190-30-20S	20	DG179-190-30-36L	36
20.0	30.0	0.02	DG179-200-30-20S	20	DG179-200-30-36L	36
21.0	30.0	0.02			DG179-210-30-36L	36
22.0	30.0	0.02			DG179-220-30-36L	36
24.0	35.0	0.02	DG179-240-35-20S	20	DG179-240-35-36L	36
25.0	35.0	0.02	DG179-250-35-20S	20	DG179-250-35-36L	36
26.0	35.0	0.02	DG179-260-35-20S	20	DG179-260-35-36L	36
28.0	42.0	0.02	DG179-280-42-20S	20		36
30.0	42.0	0.02	DG179-300-42-20S	20	DG179-300-42-36L	36
32.0	48.0	0.04	DG179-320-48-25S	25	DG179-320-48-45L	45