

Materials: INOX. 1.4034
 Hardness: 51 ± 3 HRC.
 Max. working temp 150°C Patented System

Inner insert is always at the same level as the body of the date stamp.
 Wide range of diameters. Only a H7 pocket required for assembly.
 No downtime when changing inserts. Internal mechanism guarantees secure replacement of inserts.

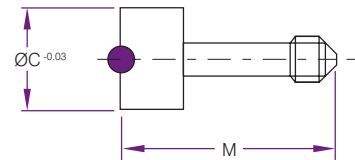

12 Months	12 Month + Year	Year	Blank	A	C	D	E	L	N
FA0422SF	FA042212-...	FA042204-...	FA042200	4	2.2	6	3.5	12	4
FA0530SF	FA053012-...	FA053004-...	FA053000	5	3	6	3.5	12	4
FA0632SF	FA063212-...	FA063205-...	FA063200	6	3.2	12	4	20	5
FA0847SF	FA084712-...	FA084705-...	FA084700	8	4.7	12	6	20	5
FA1057SF	FA105712-...	FA105706-...	FA105700	10	5.7	12	8	20	6
FA1267SF	FA126712-...	FA126708-...	FA126700	12	6.7	12	10	20	8
FA1687SF	FA168712-...	FA168710-...	FA168700	16	8.7	12	12	20	10
FA2007SF	FA200712-...	FA200710-...	FA200700	20	10.7	12	14	20	10



Material: INOX. 1.4034
 Hardness: 51 ± 3 HRC.

Year + Arrow



Year and Arrow

Product Code	C	M
IA2275 . .	2.2	7.5
IA3075 . .	3	7.5
IA3217 . .	3.2	17
IA4717 . .	4.7	17
IA5717 . .	5.7	17
IA6717 . .	6.7	17
IA8717 . .	8.7	17
IA1007 . .	10.7	17

IMPORTANT
 When replacing the insert, be sure to tighten until hearing the engagement "click".

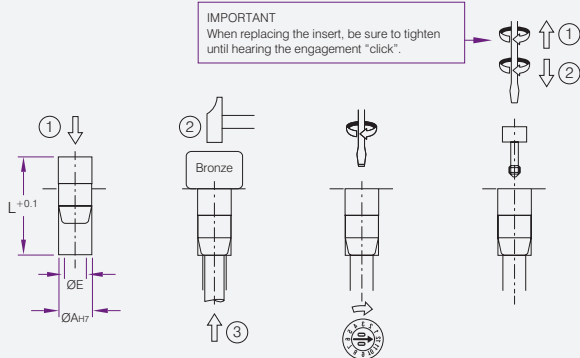

Arrow Only



Arrow Only

Product Code	C	M
IA2275SF	2.2	7.5
IA3075SF	3	7.5
IA3217SF	3.2	17
IA4717SF	4.7	17
IA5717SF	5.7	17
IA6717SF	6.7	17
IA8717SF	8.7	17
IA1007SF	10.7	17