

Materials: (HSS) M2, Tungsten High Speed Steel

Shank Hardness: 64 +/- 2 Hrc
 Head Hardness: 50 +/- 5 Hrc.

DIA d1	d2 +/- 0.1	K +0.2 R-3	HSS		
			70	80	100
0.50	0.9	0.2	DF-0050-070-M2		
0.55	1.0	0.2	DF-0055-070-M2		
0.60	1.1	0.2	DF-0060-070-M2		
0.65	1.2	0.2	DF-0065-070-M2		
0.70	1.3	0.2	DF-0070-070-M2		
0.75	1.3	0.2	DF-0075-070-M2		
0.80	1.4	0.4	DF-0080-070-M2		
0.85	1.4	0.4	DF-0085-070-M2		
0.90	1.6	0.4	DF-0090-070-M2		
0.95	1.6	0.4	DF-0095-070-M2		
1.00	1.8	0.5	DF-0100-070-M2	DF-0100-080-M2	DF-0100-100-M2
1.05	1.8	0.5	DF-0105-070-M2		
1.10	1.8	0.5	DF-0110-070-M2	DF-0110-080-M2	DF-0110-100-M2
1.15	2.0	0.5	DF-0115-070-M2		
1.20	2.0	0.5	DF-0120-070-M2	DF-0120-080-M2	DF-0120-100-M2
1.25	2.0	0.5	DF-0125-070-M2	DF-0125-080-M2	DF-0125-100-M2
1.30	2.0	0.5	DF-0130-070-M2	DF-0130-080-M2	DF-0130-100-M2
1.35	2.2	0.5	DF-0135-070-M2		
1.40	2.2	0.5	DF-0140-070-M2	DF-0140-080-M2	DF-0140-100-M2
1.45	2.2	0.5	DF-0145-070-M2		
1.50	2.2	0.5	DF-0150-070-M2	DF-0150-080-M2	DF-0150-100-M2
1.55	2.5	0.5	DF-0155-070-M2		
1.60	2.5	0.5	DF-0160-070-M2	DF-0160-080-M2	DF-0160-100-M2
1.65	2.5	0.5	DF-0165-070-M2		
1.70	2.5	0.5	DF-0170-070-M2	DF-0170-080-M2	DF-0170-100-M2
1.75	2.8	0.5	DF-0175-070-M2	DF-0175-080-M2	DF-0175-100-M2
1.80	2.8	0.5	DF-0180-070-M2	DF-0180-080-M2	DF-0180-100-M2
1.85	2.8	0.5	DF-0185-070-M2		
1.90	2.8	0.5	DF-0190-070-M2	DF-0190-080-M2	DF-0190-100-M2
1.95	3.0	0.5	DF-0195-070-M2		
2.00	3.0	0.5	DF-0200-070-M2	DF-0200-080-M2	DF-0200-100-M2
2.05	3.2	0.5	DF-0205-070-M2		
2.10	3.2	0.5	DF-0210-070-M2	DF-0210-080-M2	DF-0210-100-M2
2.15	3.2	0.5	DF-0215-070-M2		
2.20	3.2	0.5	DF-0220-070-M2	DF-0220-080-M2	DF-0220-100-M2
2.25	3.5	0.5	DF-0225-070-M2	DF-0225-080-M2	DF-0225-100-M2
2.30	3.5	0.5	DF-0230-070-M2	DF-0230-080-M2	DF-0230-100-M2
2.35	3.5	0.5	DF-0235-070-M2		
2.40	3.5	0.5	DF-0240-070-M2	DF-0240-080-M2	DF-0240-100-M2
2.45	3.5	0.5	DF-0245-070-M2		
2.50	3.5	0.5	DF-0250-070-M2	DF-0250-080-M2	DF-0250-100-M2
2.55	4.0	0.5	DF-0255-070-M2		
2.60	4.0	0.5	DF-0260-070-M2	DF-0260-080-M2	DF-0260-100-M2
2.65	4.0	0.5	DF-0265-070-M2		
2.70	4.0	0.5	DF-0270-070-M2	DF-0270-080-M2	DF-0270-100-M2
2.75	4.0	0.5	DF-0275-070-M2	DF-0275-080-M2	DF-0275-100-M2
2.80	4.0	0.5	DF-0280-070-M2	DF-0280-080-M2	DF-0280-100-M2
2.85	4.0	0.5	DF-0285-070-M2		
2.90	4.0	0.5	DF-0290-070-M2	DF-0290-080-M2	DF-0290-100-M2
2.95	4.0	0.5	DF-0295-070-M2		
3.00	4.5	0.5	DF-0300-070-M2	DF-0300-080-M2	DF-0300-100-M2
3.05	4.5	0.5	DF-0305-070-M2		

Materials: (A2) 12% Chromium Tool Steel

Shank Hardness: 62 +/- 2 Hrc
 Head Hardness: 40 +/- 5 Hrc.

DIA d1	d2 +/- 0.1	K +0.2 R-3	A2		
			70	80	100
0.55	1.0	0.2	DF-0055-070-A2		
0.60	1.1	0.2	DF-0060-070-A2		
0.65	1.2	0.2	DF-0065-070-A2		
0.70	1.3	0.2	DF-0070-070-A2		
0.75	1.3	0.2	DF-0075-070-A2		
0.80	1.4	0.4	DF-0080-070-A2		
0.85	1.4	0.4	DF-0085-070-A2		
0.90	1.6	0.4	DF-0090-070-A2		
0.95	1.6	0.4	DF-0095-070-A2		
1.00	1.8	0.5	DF-0100-070-A2	DF-0100-080-A2	DF-0100-100-A2
1.05	1.8	0.5	DF-0105-070-A2		
1.10	1.8	0.5	DF-0110-070-A2	DF-0110-080-A2	DF-0110-100-A2
1.15	2.0	0.5	DF-0115-070-A2		
1.20	2.0	0.5	DF-0120-070-A2	DF-0120-080-A2	DF-0120-100-A2
1.25	2.0	0.5	DF-0125-070-A2	DF-0125-080-A2	DF-0125-100-A2
1.30	2.0	0.5	DF-0130-070-A2	DF-0130-080-A2	DF-0130-100-A2
1.35	2.2	0.5	DF-0135-070-A2		
1.40	2.2	0.5	DF-0140-070-A2	DF-0140-080-A2	DF-0140-100-A2
1.45	2.2	0.5	DF-0145-070-A2		
1.50	2.2	0.5	DF-0150-070-A2	DF-0150-080-A2	DF-0150-100-A2
1.55	2.5	0.5	DF-0155-070-A2		
1.60	2.5	0.5	DF-0160-070-A2	DF-0160-080-A2	DF-0160-100-A2
1.65	2.5	0.5	DF-0165-070-A2	DF-0165-080-A2	
1.70	2.5	0.5	DF-0170-070-A2	DF-0170-080-A2	DF-0170-100-A2
1.75	2.8	0.5	DF-0175-070-A2	DF-0175-080-A2	DF-0175-100-A2
1.80	2.8	0.5	DF-0180-070-A2	DF-0180-080-A2	DF-0180-100-A2
1.85	2.8	0.5	DF-0185-070-A2		
1.90	2.8	0.5	DF-0190-070-A2	DF-0190-080-A2	DF-0190-100-A2
1.95	3.0	0.5	DF-0195-070-A2		
2.00	3.0	0.5	DF-0200-070-A2	DF-0200-080-A2	DF-0200-100-A2
2.05	3.2	0.5	DF-0205-070-A2		
2.10	3.2	0.5	DF-0210-070-A2	DF-0210-080-A2	DF-0210-100-A2
2.15	3.2	0.5	DF-0215-070-A2		
2.20	3.2	0.5	DF-0220-070-A2	DF-0220-080-A2	
2.25	3.5	0.5	DF-0225-070-A2	DF-0225-080-A2	DF-0225-100-A2
2.30	3.5	0.5	DF-0230-070-A2	DF-0230-080-A2	DF-0230-100-A2
2.35	3.5	0.5	DF-0235-070-A2		
2.40	3.5	0.5	DF-0240-070-A2	DF-0240-080-A2	DF-0240-100-A2
2.45	3.5	0.5	DF-0245-070-A2		
2.50	3.5	0.5	DF-0250-070-A2	DF-0250-080-A2	DF-0250-100-A2
2.55	4.0	0.5	DF-0255-070-A2		
2.60	4.0	0.5	DF-0260-070-A2	DF-0260-080-A2	DF-0260-100-A2
2.65	4.0	0.5	DF-0265-070-A2		
2.70	4.0	0.5	DF-0270-070-A2	DF-0270-080-A2	DF-0270-100-A2
2.75	4.0	0.5	DF-0275-070-A2	DF-0275-080-A2	DF-0275-100-A2
2.80	4.0	0.5	DF-0280-070-A2	DF-0280-080-A2	DF-0280-100-A2
2.85	4.0	0.5	DF-0285-070-A2		
2.90	4.0	0.5	DF-0290-070-A2	DF-0290-080-A2	DF-0290-100-A2
2.95	4.0	0.5	DF-0295-070-A2		
3.00	4.5	0.5	DF-0300-070-A2	DF-0300-080-A2	DF-0300-100-A2

Continued next page

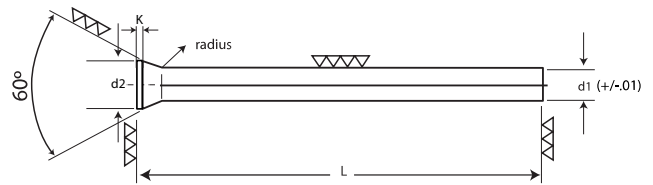

Materials: (HSS) M2, Tungsten High Speed Steel

Shank Hardness: 64 +/- 2 Hrc

Head Hardness: 50 +/- 5 Hrc.

DIA d1	d2 +/- 0.1	K +0.2 R-3	HSS		
			70	80	100
3.10	4.5	0.5	DF-0310-070-M2	DF-0310-080-M2	DF-0310-100-M2
3.15	4.5	0.5	DF-0315-070-M2		
3.20	4.5	0.5	DF-0320-070-M2	DF-0320-080-M2	DF-0320-100-M2
3.25	4.5	0.5	DF-0325-070-M2	DF-0325-080-M2	DF-0325-100-M2
3.30	4.5	0.5	DF-0330-070-M2	DF-0330-080-M2	DF-0330-100-M2
3.35	4.5	0.5	DF-0335-070-M2		
3.40	4.5	0.5	DF-0340-070-M2	DF-0340-080-M2	DF-0340-100-M2
3.45	4.5	0.5	DF-0345-070-M2		
3.50	5.0	0.5	DF-0350-070-M2	DF-0350-080-M2	DF-0350-100-M2
3.55	5.0	0.5	DF-0355-070-M2		
3.60	5.0	0.5	DF-0360-070-M2	DF-0360-080-M2	DF-0360-100-M2
3.65	5.0	0.5	DF-0365-070-M2	DF-0365-080-M2	
3.70	5.0	0.5	DF-0370-070-M2	DF-0370-080-M2	DF-0370-100-M2
3.75	5.0	0.5	DF-0375-070-M2	DF-0375-080-M2	DF-0375-100-M2
3.80	5.0	0.5	DF-0380-070-M2	DF-0380-080-M2	DF-0380-100-M2
3.85	5.0	0.5	DF-0385-070-M2		
3.90	5.0	0.5	DF-0390-070-M2	DF-0380-080-M2	DF-0390-100-M2
3.95	5.0	0.5	DF-0395-070-M2	DF-0395-080-M2	
4.00	5.5	0.5	DF-0400-070-M2	DF-0400-080-M2	DF-0400-100-M2
4.05	5.5	0.5	DF-0405-070-M2		
4.10	5.5	0.5	DF-0410-070-M2	DF-0410-080-M2	DF-0410-100-M2
4.15	5.5	0.5	DF-0415-070-M2		
4.20	5.5	0.5	DF-0420-070-M2	DF-0420-080-M2	DF-0420-100-M2
4.25	5.5	0.5	DF-0425-070-M2	DF-0425-080-M2	DF-0425-100-M2
4.30	5.5	0.5	DF-0430-070-M2	DF-0430-080-M2	DF-0430-100-M2
4.35	5.5	0.5	DF-0435-070-M2		
4.40	5.5	0.5	DF-0440-070-M2	DF-0440-080-M2	DF-0440-100-M2
4.45	5.5	0.5	DF-0445-070-M2		
4.50	6.0	0.5	DF-0450-070-M2	DF-0450-080-M2	DF-0450-100-M2
4.55	6.0	0.5	DF-0455-070-M2		
4.60	6.0	0.5	DF-0460-070-M2	DF-0460-080-M2	DF-0460-100-M2
4.65	6.0	0.5	DF-0465-070-M2		
4.70	6.0	0.5	DF-0470-070-M2	DF-0470-080-M2	DF-0470-100-M2
4.75	6.0	0.5	DF-0475-070-M2	DF-0475-080-M2	DF-0475-100-M2
4.80	6.0	0.5	DF-0480-070-M2	DF-0480-080-M2	DF-0480-100-M2
4.85	6.0	0.5	DF-0485-070-M2		
4.90	6.0	0.5	DF-0490-070-M2	DF-0490-080-M2	DF-0490-100-M2
4.95	6.0	0.5	DF-0495-070-M2		
5.00	6.5	0.5	DF-0500-070-M2	DF-0500-080-M2	DF-0500-100-M2
5.05	6.5	0.5	DF-0505-070-M2		
5.10	6.5	0.5	DF-0510-070-M2	DF-0510-080-M2	DF-0510-100-M2
5.15	6.5	0.5	DF-0515-070-M2		
5.20	6.5	0.5	DF-0520-070-M2	DF-0520-080-M2	DF-0520-100-M2
5.25	6.5	0.5	DF-0525-070-M2	DF-0525-080-M2	DF-0525-100-M2
5.30	6.5	0.5	DF-0530-070-M2	DF-0530-080-M2	DF-0530-100-M2
5.35	6.5	0.5	DF-0535-070-M2		
5.40	6.5	0.5	DF-0540-070-M2	DF-0540-080-M2	DF-0540-100-M2
5.45	6.5	0.5	DF-0545-070-M2		
5.50	7.0	0.5	DF-0550-070-M2	DF-0550-080-M2	DF-0550-100-M2
5.55	7.0	0.5	DF-0555-070-M2		
5.60	7.0	0.5	DF-0560-070-M2	DF-0560-080-M2	DF-0560-100-M2
5.65	7.0	0.5	DF-0565-070-M2		

Materials: (A2) 12% Chromium Tool Steel

Shank Hardness: 62 +/- 2 Hrc

Head Hardness: 40 +/- 5 Hrc.

DIA d1	d2 +/- 0.1	K +0.2 R-3	A2		
			70	80	100
3.10	4.5	0.5	DF-0310-070-A2	DF-0310-080-A2	DF-0310-100-A2
3.20	4.5	0.5	DF-0320-070-A2	DF-0320-080-A2	DF-0320-100-A2
3.25	4.5	0.5	DF-0325-070-A2	DF-0325-080-A2	DF-0325-100-A2
3.30	4.5	0.5	DF-0330-070-A2	DF-0330-080-A2	DF-0330-100-A2
3.40	4.5	0.5	DF-0340-070-A2	DF-0340-080-A2	DF-0340-100-A2
3.50	5.0	0.5	DF-0350-070-A2	DF-0350-080-A2	DF-0350-100-A2
3.60	5.0	0.5	DF-0360-070-A2	DF-0360-080-A2	DF-0360-100-A2
3.65	5.0	0.5	DF-0365-070-A2	DF-0365-080-A2	
3.70	5.0	0.5	DF-0370-070-A2	DF-0370-080-A2	DF-0370-100-A2
3.75	5.0	0.5	DF-0375-070-A2	DF-0375-080-A2	DF-0375-100-A2
3.80	5.0	0.5	DF-0380-070-A2	DF-0380-080-A2	DF-0380-100-A2
3.90	5.0	0.5	DF-0390-070-A2	DF-0390-080-A2	DF-0390-100-A2
3.95	5.0	0.5	DF-0395-070-A2	DF-0395-080-A2	
4.00	5.5	0.5	DF-0400-070-A2	DF-0400-080-A2	DF-0400-100-A2
4.10	5.5	0.5	DF-0410-070-A2	DF-0410-080-A2	DF-0410-100-A2
4.20	5.5	0.5	DF-0420-070-A2	DF-0420-080-A2	DF-0420-100-A2
4.25	5.5	0.5	DF-0425-070-A2	DF-0425-080-A2	DF-0425-100-A2
4.30	5.5	0.5	DF-0430-070-A2	DF-0430-080-A2	DF-0430-100-A2
4.40	5.5	0.5	DF-0440-070-A2	DF-0440-080-A2	DF-0440-100-A2
4.50	6.0	0.5	DF-0450-070-A2	DF-0450-080-A2	DF-0450-100-A2
4.60	6.0	0.5	DF-0460-070-A2	DF-0460-080-A2	DF-0460-100-A2
4.70	6.0	0.5	DF-0470-070-A2	DF-0470-080-A2	DF-0470-100-A2
4.75	6.0	0.5	DF-0475-070-A2	DF-0475-080-A2	DF-0475-100-A2
4.80	6.0	0.5	DF-0480-070-A2	DF-0480-080-A2	DF-0480-100-A2
4.90	6.0	0.5	DF-0490-070-A2	DF-0490-080-A2	DF-0490-100-A2
5.00	6.5	0.5	DF-0500-070-A2	DF-0500-080-A2	DF-0500-100-A2
5.10	6.5	0.5	DF-0510-070-A2	DF-0510-080-A2	DF-0510-100-A2
5.20	6.5	0.5	DF-0520-070-A2	DF-0520-080-A2	DF-0520-100-A2
5.25	6.5	0.5	DF-0525-070-A2	DF-0525-080-A2	DF-0525-100-A2
5.30	6.5	0.5	DF-0530-070-A2	DF-0530-080-A2	DF-0530-100-A2
5.40	6.5	0.5	DF-0540-070-A2	DF-0540-080-A2	DF-0540-100-A2
5.50	7.0	0.5	DF-0550-070-A2	DF-0550-080-A2	DF-0550-100-A2
5.60	7.0	0.5	DF-0560-070-A2	DF-0560-080-A2	

Continued next page

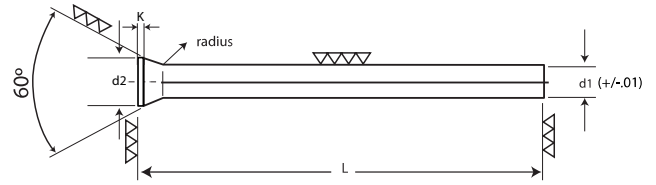

Materials: (HSS) M2, Tungsten High Speed Steel

Shank Hardness: 64 +/- 2 Hrc
Head Hardness: 50 +/- 5 Hrc.

Materials: (A2) 12% Chromium Tool Steel

Shank Hardness: 62 +/- 2 Hrc
Head Hardness: 40 +/- 5 Hrc.

DIA d1	d2 +/- 0.1	K +0.2 R-3	HSS		
			70	80	100
5.70	7.0	0.5	DF-0570-070-M2	DF-0570-080-M2	DF-0570-100-M2
5.75	7.0	0.5	DF-0575-070-M2		DF-0575-100-M2
5.80	7.0	0.5	DF-0580-070-M2	DF-0580-080-M2	DF-0580-100-M2
5.85	7.0	0.5	DF-0585-070-M2		
5.90	7.0	0.5	DF-0590-070-M2	DF-0590-080-M2	DF-0590-100-M2
5.95	7.0	0.5	DF-0595-070-M2		
6.00	8.0	0.5	DF-0600-070-M2	DF-0600-080-M2	DF-0600-100-M2
6.10	8.0	0.5	DF-0610-070-M2	DF-0610-080-M2	DF-0610-100-M2
6.20	8.0	0.5	DF-0620-070-M2	DF-0620-080-M2	DF-0620-100-M2
6.25	8.0	0.5	DF-0625-070-M2	DF-0625-080-M2	DF-0625-100-M2
6.30	8.0	0.5	DF-0630-070-M2	DF-0630-080-M2	DF-0630-100-M2
6.40	8.0	0.5	DF-0640-070-M2	DF-0640-080-M2	DF-0640-100-M2
6.50	9.0	1.0	DF-0650-070-M2	DF-0650-080-M2	DF-0650-100-M2
6.60	9.0	1.0	DF-0660-070-M2	DF-0660-080-M2	DF-0660-100-M2
6.70	9.0	1.0	DF-0670-070-M2	DF-0670-080-M2	DF-0670-100-M2
6.75	9.0	1.0	DF-0675-070-M2	DF-0675-080-M2	DF-0675-100-M2
6.80	9.0	1.0	DF-0680-070-M2	DF-0680-080-M2	DF-0680-100-M2
6.90	9.0	1.0	DF-0690-070-M2	DF-0690-080-M2	DF-0690-100-M2
7.00	9.0	1.0	DF-0700-070-M2	DF-0700-080-M2	DF-0700-100-M2
7.10	9.0	1.0	DF-0710-070-M2	DF-0710-080-M2	DF-0710-100-M2
7.20	9.0	1.0	DF-0720-070-M2	DF-0720-080-M2	DF-0720-100-M2
7.25	9.0	1.0	DF-0725-070-M2	DF-0725-080-M2	DF-0725-100-M2
7.30	9.0	1.0	DF-0730-070-M2	DF-0730-080-M2	DF-0730-100-M2
7.40	9.0	1.0	DF-0740-070-M2	DF-0740-080-M2	DF-0740-100-M2
7.50	10	1.0	DF-0750-070-M2	DF-0750-080-M2	DF-0750-100-M2
7.60	10	1.0	DF-0760-070-M2	DF-0760-080-M2	DF-0760-100-M2
7.70	10	1.0	DF-0770-070-M2	DF-0770-080-M2	DF-0770-100-M2
7.75	10	1.0	DF-0775-070-M2	DF-0775-080-M2	DF-0775-100-M2
7.80	10	1.0	DF-0780-070-M2	DF-0780-080-M2	DF-0780-100-M2
7.90	10	1.0	DF-0790-070-M2	DF-0790-080-M2	DF-0790-100-M2
8.00	10	1.0	DF-0800-070-M2	DF-0800-080-M2	DF-0800-100-M2
8.10	10	1.0	DF-0810-070-M2	DF-0810-080-M2	DF-0810-100-M2
8.20	10	1.0	DF-0820-070-M2	DF-0820-080-M2	DF-0820-100-M2
8.25	10	1.0	DF-0825-070-M2	DF-0825-080-M2	DF-0825-100-M2
8.30	10	1.0	DF-0830-070-M2	DF-0830-080-M2	DF-0830-100-M2
8.40	10	1.0	DF-0840-070-M2	DF-0840-080-M2	DF-0840-100-M2
8.50	11	1.0	DF-0850-070-M2	DF-0850-080-M2	DF-0850-100-M2
8.60	11	1.0	DF-0860-070-M2	DF-0860-080-M2	DF-0860-100-M2
8.70	11	1.0	DF-0870-070-M2	DF-0870-080-M2	DF-0870-100-M2
8.75	11	1.0	DF-0875-070-M2	DF-0875-080-M2	DF-0875-100-M2
8.80	11	1.0	DF-0880-070-M2	DF-0880-080-M2	DF-0880-100-M2
8.90	11	1.0	DF-0890-070-M2	DF-0890-080-M2	DF-0890-100-M2
9.00	11	1.0	DF-0900-070-M2	DF-0900-080-M2	DF-0900-100-M2
9.10	11	1.0	DF-0910-070-M2	DF-0910-080-M2	DF-0910-100-M2
9.20	11	1.0	DF-0920-070-M2	DF-0920-080-M2	DF-0920-100-M2
9.25	11	1.0	DF-0925-070-M2	DF-0925-080-M2	DF-0925-100-M2
9.30	11	1.0	DF-0930-070-M2	DF-0930-080-M2	DF-0930-100-M2
9.40	11	1.0	DF-0940-070-M2	DF-0940-080-M2	DF-0940-100-M2
9.50	12	1.0	DF-0950-070-M2	DF-0950-080-M2	DF-0950-100-M2
9.60	12	1.0	DF-0960-070-M2	DF-0960-080-M2	DF-0960-100-M2
9.70	12	1.0	DF-0970-070-M2	DF-0970-080-M2	DF-0970-100-M2
9.75	12	1.0	DF-0975-070-M2	DF-0975-080-M2	DF-0975-100-M2

DIA d1	d2 +/- 0.1	K +0.2 R-3	A2		
			70	80	100
5.70	7.0	0.5	DF-0570-070-A2	DF-0570-080-A2	DF-0570-100-A2
5.75	7.0	0.5	DF-0575-070-A2	DF-0575-080-A2	DF-0575-100-A2
5.80	7.0	0.5	DF-0580-070-A2	DF-0580-080-A2	DF-0580-100-A2
5.90	7.0	0.5	DF-0590-070-A2	DF-0590-080-A2	DF-0590-100-A2
6.00	8.0	0.5	DF-0600-070-A2	DF-0600-080-A2	DF-0600-100-A2
6.10	8.0	0.5	DF-0610-070-A2	DF-0610-080-A2	DF-0610-100-A2
6.20	8.0	0.5	DF-0620-070-A2	DF-0620-080-A2	DF-0620-100-A2
6.25	8.0	0.5	DF-0625-070-A2	DF-0625-080-A2	DF-0625-100-A2
6.30	8.0	0.5	DF-0630-070-A2	DF-0630-080-A2	DF-0630-100-A2
6.40	8.0	0.5	DF-0640-070-A2	DF-0640-080-A2	DF-0640-100-A2
6.50	9.0	1.0	DF-0650-070-A2	DF-0650-080-A2	
6.60	9.0	1.0	DF-0660-070-A2	DF-0660-080-A2	DF-0660-100-A2
6.70	9.0	1.0	DF-0670-070-A2	DF-0670-080-A2	DF-0670-100-A2
6.75	9.0	1.0	DF-0675-070-A2	DF-0675-080-A2	DF-0675-100-A2
6.80	9.0	1.0	DF-0680-070-A2	DF-0680-080-A2	DF-0680-100-A2
6.90	9.0	1.0	DF-0690-070-A2	DF-0690-080-A2	DF-0690-100-A2
7.00	9.0	1.0	DF-0700-070-A2	DF-0700-080-A2	DF-0700-100-A2
7.10	9.0	1.0	DF-0710-070-A2	DF-0710-080-A2	DF-0710-100-A2
7.20	9.0	1.0	DF-0720-070-A2	DF-0720-080-A2	DF-0720-100-A2
7.25	9.0	1.0	DF-0725-070-A2	DF-0725-080-A2	DF-0725-100-A2
7.30	9.0	1.0	DF-0730-070-A2	DF-0730-080-A2	DF-0730-100-A2
7.40	9.0	1.0	DF-0740-070-A2	DF-0740-080-A2	DF-0740-100-A2
7.50	10	1.0	DF-0750-070-A2	DF-0750-080-A2	DF-0750-100-A2
7.60	10	1.0	DF-0760-070-A2	DF-0760-080-A2	DF-0760-100-A2
7.70	10	1.0	DF-0770-070-A2	DF-0770-080-A2	DF-0770-100-A2
7.75	10	1.0	DF-0775-070-A2	DF-0775-080-A2	DF-0775-100-A2
7.80	10	1.0	DF-0780-070-A2	DF-0780-080-A2	DF-0780-100-A2
7.90	10	1.0	DF-0790-070-A2	DF-0790-080-A2	DF-0790-100-A2
8.00	10	1.0	DF-0800-070-A2	DF-0800-080-A2	DF-0800-100-A2
8.10	10	1.0	DF-0810-070-A2	DF-0810-080-A2	DF-0810-100-A2
8.20	10	1.0	DF-0820-070-A2	DF-0820-080-A2	DF-0820-100-A2
8.25	10	1.0	DF-0825-070-A2	DF-0825-080-A2	DF-0825-100-A2
8.30	10	1.0	DF-0830-070-A2	DF-0830-080-A2	DF-0830-100-A2
8.40	10	1.0	DF-0840-070-A2	DF-0840-080-A2	DF-0840-100-A2
8.50	11	1.0	DF-0850-070-A2	DF-0850-080-A2	DF-0850-100-A2
8.60	11	1.0	DF-0860-070-A2	DF-0860-080-A2	DF-0860-100-A2
8.70	11	1.0	DF-0870-070-A2	DF-0870-080-A2	DF-0870-100-A2
8.75	11	1.0	DF-0875-070-A2	DF-0875-080-A2	DF-0875-100-A2
8.80	11	1.0	DF-0880-070-A2	DF-0880-080-A2	DF-0880-100-A2
8.90	11	1.0	DF-0890-070-A2	DF-0890-080-A2	DF-0890-100-A2
9.00	11	1.0	DF-0900-070-A2	DF-0900-080-A2	DF-0900-100-A2
9.10	11	1.0	DF-0910-070-A2	DF-0910-080-A2	DF-0910-100-A2
9.20	11	1.0	DF-0920-070-A2	DF-0920-080-A2	DF-0920-100-A2
9.25	11	1.0	DF-0925-070-A2	DF-0925-080-A2	DF-0925-100-A2
9.30	11	1.0	DF-0930-070-A2	DF-0930-080-A2	DF-0930-100-A2
9.40	11	1.0	DF-0940-070-A2	DF-0940-080-A2	DF-0940-100-A2
9.50	12	1.0	DF-0950-070-A2	DF-0950-080-A2	DF-0950-100-A2
9.60	12	1.0	DF-0960-070-A2	DF-0960-080-A2	DF-0960-100-A2
9.70	12	1.0	DF-0970-070-A2	DF-0970-080-A2	DF-0970-100-A2
9.75	12	1.0	DF-0975-070-A2	DF-0975-080-A2	DF-0975-100-A2

Continued next page

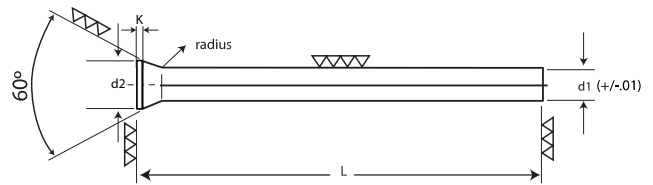

Materials: (HSS) M2, Tungsten High Speed Steel

Shank Hardness: 64 +/- 2 Hrc

Head Hardness: 50 +/- 5 Hrc.

DIA d1	d2 +/- 0.1	K +0.2 R-3	HSS		
			70	80	100
9.80	12	1.0	DF-0980-070-M2	DF-0980-080-M2	DF-0980-100-M2
9.90	12	1.0	DF-0990-070-M2	DF-0990-080-M2	DF-0990-100-M2
10.00	12	1.0	DF-1000-070-M2	DF-1000-080-M2	DF-1000-100-M2
10.10	12	1.0	DF-1010-070-M2	DF-1010-080-M2	DF-1010-100-M2
10.20	12	1.0	DF-1020-070-M2	DF-1020-080-M2	DF-1020-100-M2
10.25	12	1.0	DF-1025-070-M2	DF-1025-080-M2	DF-1025-100-M2
10.30	12	1.0	DF-1030-070-M2	DF-1030-080-M2	DF-1030-100-M2
10.40	12	1.0	DF-1040-070-M2	DF-1040-080-M2	DF-1040-100-M2
10.50	13	1.0	DF-1050-070-M2	DF-1050-080-M2	DF-1050-100-M2
10.60	13	1.0	DF-1060-070-M2	DF-1060-080-M2	DF-1060-100-M2
10.70	13	1.0	DF-1070-070-M2	DF-1070-080-M2	DF-1070-100-M2
10.75	13	1.0	DF-1075-070-M2	DF-1075-080-M2	DF-1075-100-M2
10.80	13	1.0	DF-1080-070-M2	DF-1080-080-M2	DF-1080-100-M2
10.90	13	1.0	DF-1090-070-M2	DF-1090-080-M2	DF-1090-100-M2
11.00	13	1.0	DF-1100-070-M2	DF-1100-080-M2	DF-1100-100-M2
11.10	13	1.0	DF-1110-070-M2	DF-1110-080-M2	DF-1110-100-M2
11.20	13	1.0	DF-1120-070-M2	DF-1120-080-M2	DF-1120-100-M2
11.25	13	1.0	DF-1125-070-M2	DF-1125-080-M2	DF-1125-100-M2
11.30	13	1.0	DF-1130-070-M2	DF-1130-080-M2	DF-1130-100-M2
11.40	13	1.0	DF-1140-070-M2	DF-1140-080-M2	DF-1140-100-M2
11.50	14	1.0	DF-1150-070-M2	DF-1150-080-M2	DF-1150-100-M2
11.60	14	1.0	DF-1160-070-M2	DF-1160-080-M2	DF-1160-100-M2
11.70	14	1.0	DF-1170-070-M2	DF-1170-080-M2	DF-1170-100-M2
11.75	14	1.0	DF-1175-070-M2	DF-1175-080-M2	DF-1175-100-M2
11.80	14	1.0	DF-1180-070-M2	DF-1180-080-M2	DF-1180-100-M2
11.90	14	1.0	DF-1190-070-M2	DF-1190-080-M2	DF-1190-100-M2
12.00	14	1.0	DF-1200-070-M2	DF-1200-080-M2	DF-1200-100-M2
12.10	14	1.0	DF-1210-070-M2	DF-1210-080-M2	DF-1210-100-M2
12.20	14	1.0	DF-1220-070-M2	DF-1220-080-M2	DF-1220-100-M2
12.25	14	1.0	DF-1225-070-M2	DF-1225-080-M2	DF-1225-100-M2
12.30	14	1.0	DF-1230-070-M2	DF-1230-080-M2	DF-1230-100-M2
12.40	14	1.0	DF-1240-070-M2	DF-1240-080-M2	DF-1240-100-M2
12.50	15	1.0	DF-1250-070-M2	DF-1250-080-M2	DF-1250-100-M2
12.60	15	1.0	DF-1260-070-M2	DF-1260-080-M2	DF-1260-100-M2
12.70	15	1.0	DF-1270-070-M2	DF-1270-080-M2	DF-1270-100-M2
12.75	15	1.0	DF-1275-070-M2	DF-1275-080-M2	DF-1275-100-M2
12.80	15	1.0	DF-1280-070-M2	DF-1280-080-M2	DF-1280-100-M2
12.90	15	1.0	DF-1290-070-M2	DF-1290-080-M2	DF-1290-100-M2
13.00	15	1.0	DF-1300-070-M2	DF-1300-080-M2	DF-1300-100-M2
13.50	16	1.0	DF-1350-070-M2	DF-1350-080-M2	DF-1350-100-M2
14.00	16	1.0	DF-1400-070-M2	DF-1400-080-M2	DF-1400-100-M2
14.50	17	1.0	DF-1450-070-M2	DF-1450-080-M2	DF-1450-100-M2
14.80	17	1.0	DF-1480-070-M2	DF-1480-080-M2	DF-1480-100-M2
15.00	17	1.0	DF-1500-070-M2	DF-1500-080-M2	DF-1500-100-M2
15.50	18	1.0	DF-1550-070-M2	DF-1550-080-M2	DF-1550-100-M2
16.00	18	1.0	DF-1600-070-M2	DF-1600-080-M2	DF-1600-100-M2
16.50	19	1.0	DF-1650-070-M2	DF-1650-080-M2	DF-1650-100-M2
17.00	19	1.0	DF-1700-070-M2	DF-1700-080-M2	DF-1700-100-M2
17.50	20	1.0	DF-1750-070-M2	DF-1750-080-M2	DF-1750-100-M2
18.00	20	1.0	DF-1800-070-M2	DF-1800-080-M2	DF-1800-100-M2
18.50	21	1.0	DF-1850-070-M2	DF-1850-080-M2	DF-1850-100-M2
19.00	21	1.0	DF-1900-070-M2	DF-1900-080-M2	DF-1900-100-M2

Materials: (A2) 12% Chromium Tool Steel

Shank Hardness: 62 +/- 2 Hrc

Head Hardness: 40 +/- 5 Hrc.

DIA d1	d2 +/- 0.1	K +0.2 R-3	A2		
			70	80	100
9.80	12	1.0	DF-0980-070-A2	DF-0980-080-A2	DF-0980-100-A2
9.90	12	1.0		DF-0990-080-A2	DF-0990-100-A2
10.00	12	1.0	DF-1000-070-A2	DF-1000-080-A2	DF-1000-100-A2
10.10	12	1.0	DF-1010-070-A2	DF-1010-080-A2	DF-1010-100-A2
10.20	12	1.0	DF-1020-070-A2	DF-1020-080-A2	DF-1020-100-A2
10.25	12	1.0	DF-1025-070-A2	DF-1025-080-A2	DF-1025-100-A2
10.30	12	1.0	DF-1030-070-A2	DF-1030-080-A2	DF-1030-100-A2
10.40	12	1.0	DF-1040-070-A2	DF-1040-080-A2	DF-1040-100-A2
10.50	13	1.0	DF-1050-070-A2	DF-1050-080-A2	DF-1050-100-A2
10.60	13	1.0	DF-1060-070-A2	DF-1060-080-A2	DF-1060-100-A2
10.70	13	1.0	DF-1070-070-A2	DF-1070-080-A2	DF-1070-100-A2
10.75	13	1.0	DF-1075-070-A2	DF-1075-080-A2	DF-1075-100-A2
10.80	13	1.0	DF-1080-070-A2	DF-1080-080-A2	DF-1080-100-A2
10.90	13	1.0	DF-1090-070-A2	DF-1090-080-A2	DF-1090-100-A2
11.00	13	1.0	DF-1100-070-A2	DF-1100-080-A2	DF-1100-100-A2
11.10	13	1.0	DF-1110-070-A2	DF-1110-080-A2	DF-1110-100-A2
11.20	13	1.0	DF-1120-070-A2	DF-1120-080-A2	DF-1120-100-A2
11.25	13	1.0	DF-1125-070-A2	DF-1125-080-A2	DF-1125-100-A2
11.30	13	1.0	DF-1130-070-A2	DF-1130-080-A2	DF-1130-100-A2
11.40	13	1.0	DF-1140-070-A2	DF-1140-080-A2	DF-1140-100-A2
11.50	14	1.0	DF-1150-070-A2	DF-1150-080-A2	DF-1150-100-A2
11.60	14	1.0	DF-1160-070-A2	DF-1160-080-A2	DF-1160-100-A2
11.70	14	1.0	DF-1170-070-A2	DF-1170-080-A2	DF-1170-100-A2
11.75	14	1.0	DF-1175-070-A2	DF-1175-080-A2	DF-1175-100-A2
11.80	14	1.0	DF-1180-070-A2	DF-1180-080-A2	DF-1180-100-A2
11.90	14	1.0	DF-1190-070-A2	DF-1190-080-A2	DF-1190-100-A2
12.00	14	1.0	DF-1200-070-A2	DF-1200-080-A2	DF-1200-100-A2
12.10	14	1.0	DF-1210-070-A2	DF-1210-080-A2	DF-1210-100-A2
12.20	14	1.0	DF-1220-070-A2	DF-1220-080-A2	DF-1220-100-A2
12.25	14	1.0	DF-1225-070-A2	DF-1225-080-A2	DF-1225-100-A2
12.30	14	1.0	DF-1230-070-A2	DF-1230-080-A2	DF-1230-100-A2
12.40	14	1.0	DF-1240-070-A2	DF-1240-080-A2	DF-1240-100-A2
12.50	15	1.0	DF-1250-070-A2	DF-1250-080-A2	DF-1250-100-A2
12.60	15	1.0	DF-1260-070-A2	DF-1260-080-A2	DF-1260-100-A2
12.70	15	1.0	DF-1270-070-A2		
12.75	15	1.0	DF-1275-070-A2	DF-1275-080-A2	DF-1275-100-A2
12.80	15	1.0	DF-1280-070-A2	DF-1280-080-A2	DF-1280-100-A2
12.90	15	1.0	DF-1290-070-A2	DF-1290-080-A2	DF-1290-100-A2
13.00	15	1.0	DF-1300-070-A2	DF-1300-080-A2	DF-1300-100-A2
13.50	16	1.0	DF-1350-070-A2	DF-1350-080-A2	DF-1350-100-A2
14.00	16	1.0	DF-1400-070-A2	DF-1400-080-A2	DF-1400-100-A2
14.50	17	1.0	DF-1450-070-A2	DF-1450-080-A2	DF-1450-100-A2
15.00	17	1.0	DF-1500-070-A2	DF-1500-080-A2	DF-1500-100-A2
15.50	18	1.0	DF-1550-070-A2	DF-1550-080-A2	DF-1550-100-A2
16.00	18	1.0	DF-1600-070-A2	DF-1600-080-A2	DF-1600-100-A2
16.50	19	1.0	DF-1650-070-A2	DF-1650-080-A2	DF-1650-100-A2
17.00	19	1.0	DF-1700-070-A2	DF-1700-080-A2	DF-1700-100-A2
17.50	20	1.0	DF-1750-070-A2	DF-1750-080-A2	DF-1750-100-A2
18.00	20	1.0	DF-1800-070-A2	DF-1800-080-A2	DF-1800-100-A2
18.50	21	1.0	DF-1850-070-A2	DF-1850-080-A2	DF-1850-100-A2
19.00	21	1.0	DF-1900-070-A2	DF-1900-080-A2	DF-1900-100-A2

Continued next page

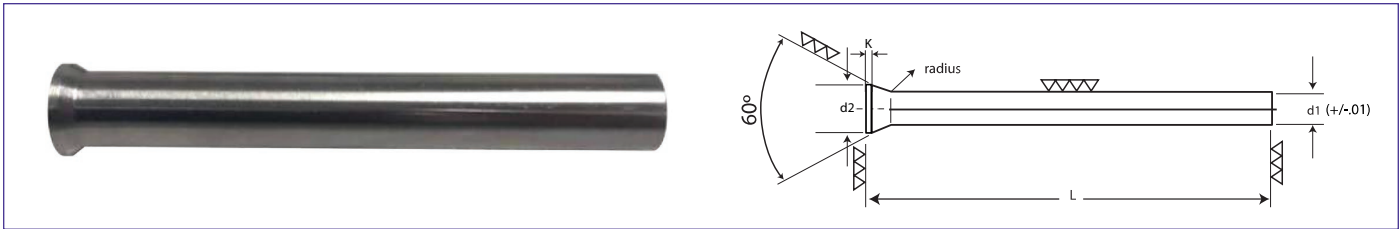

Materials: (HSS) M2, Tungsten High Speed Steel

Shank Hardness: 64 +/- 2 Hrc
 Head Hardness: 50 +/- 5 Hrc.

Materials: (A2) 12% Chromium Tool Steel

Shank Hardness: 62 +/- 2 Hrc
 Head Hardness: 40 +/- 5 Hrc.

DIA d1	d2 +/- 0.1	K +0.2 R-3	HSS		
			70	80	100
19.50	22	1.0	DF-1950-070-M2	DF-1950-080-M2	DF-1950-100-M2
20.00	22	1.0	DF-2000-070-M2	DF-2000-080-M2	DF-2000-100-M2
21.00	23	1.0	DF-2100-070-M2	DF-2100-080-M2	DF-2100-100-M2
22.00	24	1.0	DF-2200-070-M2	DF-2200-080-M2	DF-2200-100-M2
23.00	25	1.0	DF-2300-070-M2	DF-2300-080-M2	DF-2300-100-M2
24.00	26	1.0	DF-2400-070-M2	DF-2400-080-M2	DF-2400-100-M2
25.00	27	1.0	DF-2500-070-M2	DF-2500-080-M2	DF-2500-100-M2

DIA d1	d2 +/- 0.1	K +0.2 R-3	A2		
			70	80	100
19.50	22	1.0	DF-1950-070-A2	DF-1950-080-A2	DF-1950-100-A2
20.00	22	1.0	DF-2000-070-A2	DF-2000-080-A2	DF-2000-100-A2
21.00	23	1.0	DF-2100-070-A2	DF-2100-080-A2	DF-2100-100-A2
22.00	24	1.0	DF-2200-070-A2	DF-2200-080-A2	DF-2200-100-A2
23.00	25	1.0	DF-2300-070-A2	DF-2300-080-A2	DF-2300-100-A2
24.00	26	1.0	DF-2400-070-A2	DF-2400-080-A2	DF-2400-100-A2
25.00	27	1.0	DF-2500-070-A2	DF-2500-080-A2	DF-2500-100-A2

Ejector Kit

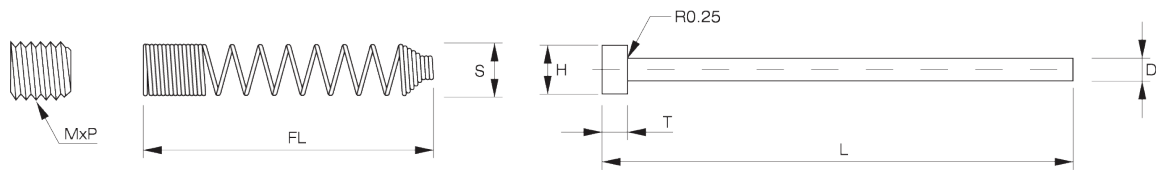
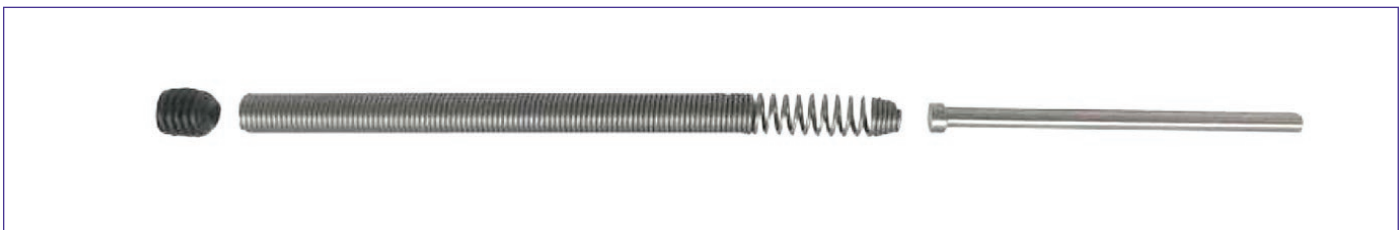

Product Code	MXP	D	L	H	T	S	FL
E2AM	M2.5XP0.45	0.51	28.2	1.2	0.79	1.95	63.5
E3M	M3XP0.5	0.69	35.0	2.0	1.19	2.54	63.5
E4M	M4XP0.7	1.04	49.3	2.4	1.58	3.35	76.2
E6M	M5XP0.8	1.47	49.3	3.2	1.58	4.14	101.6
E9M	M6XP10	2.26	56.4	3.9	2.38	5.03	101.6
E12M	M8XP10	3.00	56.4	4.7	2.38	6.60	101.6